

AWT-US500 TURNTABLE PALLET WRAPPER

FEATURES

- Compact size
- Quiet operation
- Double wrap roping on cycle completion
- Base pallet wrapping
- Touch screen control panel
- Full service maintenance plans
- Parts backup
- Excellent after sales support and operator training

OPTIONAL FEATURES

- Semi or fully-automatic
- Top sheet dispensing
- Cardboard pre-wrap
- Conveyors & accumulation – powered pallet systems and accumulation options to suit varying layouts and space availability
- Guarding - complete hazardous area requirements for personnel safety
- Powered pre-stretch film carriage – optimized film consumption
- Fully automated film clamp, welding and film cutting device

Fully automated and very dependable, the AWT-US500 has an automated film clamp, welding and film cutting device. Simply deliver your pallet to the wrapper, activate the wrapper by remote and go and collect the next pallet while the S500 wraps your pallet automatically. It's a set-and-forget unit, delivering advanced wrapping efficiency in one easy-use package.



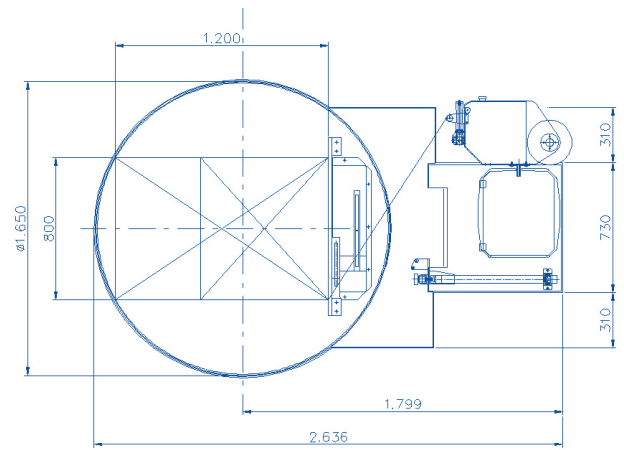
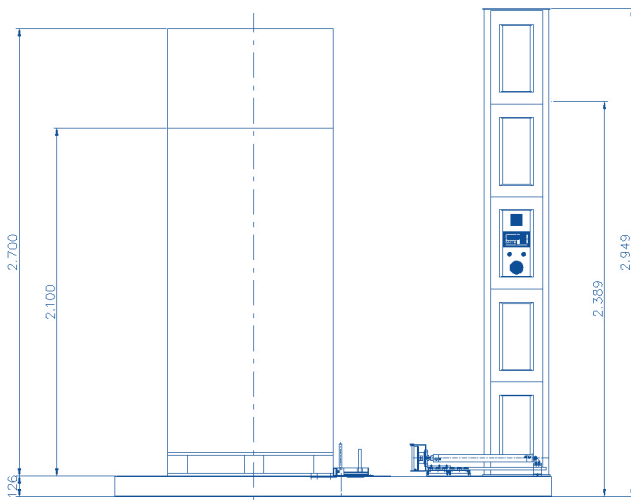

Diagram dimensions are for reference only*

Turntable table diameter	1650 mm
Turntable capacity	2000 kg
Distance between mast and turntable	500 mm
Wrap height	2600 mm
Turntable Speed	0 to 16 rpm
Production Rate Per hour	35-45 loads
Power Supply	1 Phase, 230V, 50H